

| POSITIONS/<br>CONTACTS | A     |       | B     |       |
|------------------------|-------|-------|-------|-------|
|                        | INCH  | MM    | INCH  | MM    |
| 02/02                  | 0.079 | 2.00  | 0.157 | 4.00  |
| 03/03                  | 0.157 | 4.00  | 0.236 | 6.00  |
| 04/04                  | 0.236 | 6.00  | 0.315 | 8.00  |
| 05/05                  | 0.315 | 8.00  | 0.394 | 10.00 |
| 06/06                  | 0.394 | 10.00 | 0.472 | 12.00 |
| 07/07                  | 0.472 | 12.00 | 0.551 | 14.00 |
| 08/08                  | 0.551 | 14.00 | 0.630 | 16.00 |
| 09/09                  | 0.630 | 16.00 | 0.709 | 18.00 |
| 10/10                  | 0.709 | 18.00 | 0.787 | 20.00 |
| 11/11                  | 0.787 | 20.00 | 0.866 | 22.00 |
| 12/12                  | 0.866 | 22.00 | 0.945 | 24.00 |
| 13/13                  | 0.945 | 24.00 | 1.024 | 26.00 |
| 14/14                  | 1.024 | 26.00 | 1.102 | 28.00 |
| 15/15                  | 1.102 | 28.00 | 1.181 | 30.00 |
| 16/16                  | 1.181 | 30.00 | 1.260 | 32.00 |
| 17/17                  | 1.260 | 32.00 | 1.339 | 34.00 |
| 18/18                  | 1.339 | 34.00 | 1.417 | 36.00 |
| 19/19                  | 1.417 | 36.00 | 1.496 | 38.00 |
| 20/20                  | 1.496 | 38.00 | 1.575 | 40.00 |
| 21/21                  | 1.575 | 40.00 | 1.654 | 42.00 |
| 22/22                  | 1.654 | 42.00 | 1.732 | 44.00 |
| 23/23                  | 1.732 | 44.00 | 1.811 | 46.00 |
| 24/24                  | 1.811 | 46.00 | 1.890 | 48.00 |
| 25/25                  | 1.890 | 48.00 | 1.969 | 50.00 |
| 26/26                  | 1.969 | 50.00 | 2.047 | 52.00 |
| 27/27                  | 2.047 | 52.00 | 2.126 | 54.00 |
| 28/28                  | 2.126 | 54.00 | 2.205 | 56.00 |
| 29/29                  | 2.205 | 56.00 | 2.283 | 58.00 |
| 30/30                  | 2.283 | 58.00 | 2.362 | 60.00 |
| 31/31                  | 2.362 | 60.00 | 2.441 | 62.00 |
| 32/32                  | 2.441 | 62.00 | 2.520 | 64.00 |
| 33/33                  | 2.520 | 64.00 | 2.598 | 66.00 |
| 34/34                  | 2.598 | 66.00 | 2.677 | 68.00 |
| 35/35                  | 2.677 | 68.00 | 2.756 | 70.00 |
| 36/36                  | 2.756 | 70.00 | 2.835 | 72.00 |
| 37/37                  | 2.835 | 72.00 | 2.913 | 74.00 |
| 38/38                  | 2.913 | 74.00 | 2.992 | 76.00 |
| 39/39                  | 2.992 | 76.00 | 3.071 | 78.00 |
| 40/40                  | 3.071 | 78.00 | 3.150 | 80.00 |

## PART NUMBER CODING

**NRPNxx1PAEN-RC**

### NUMBER OF POSITIONS

(CONTACTS PER ROW, 2 THRU 40)

### INSULATOR MATERIAL

N = NYLON 6T, UL 94V-0.

P = OBSOLETE, REPLACE WITH N.

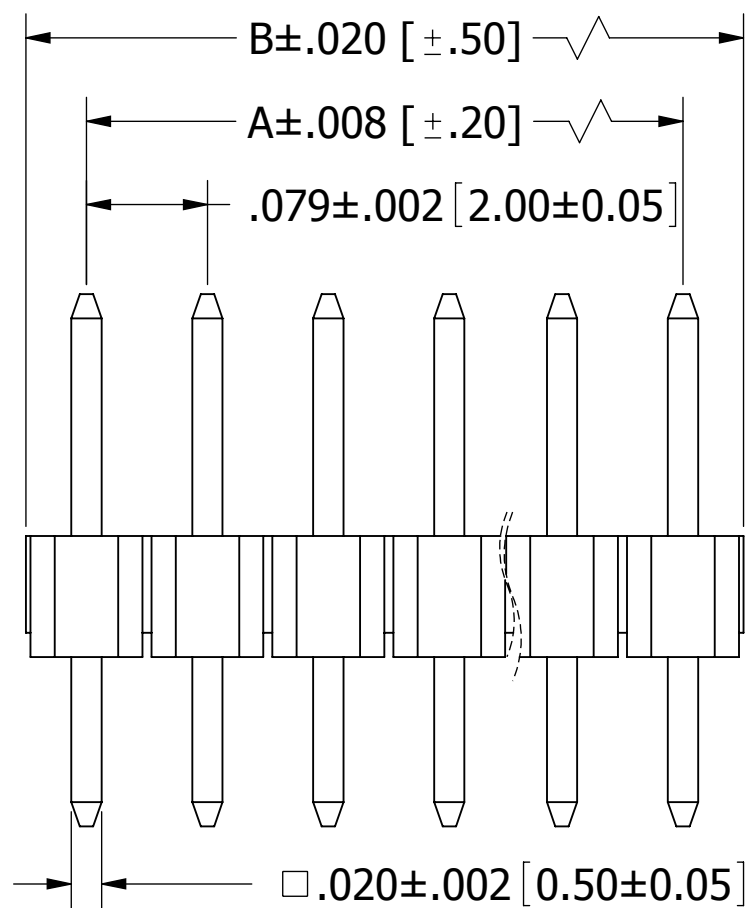
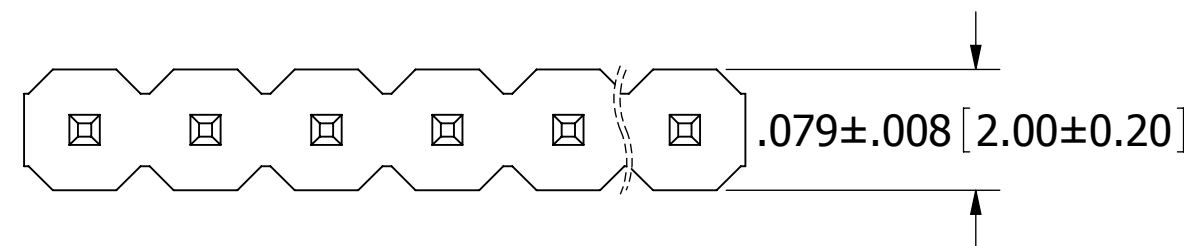

02-20, 0.20mm MAX.  
21-40, 0.30mm MAX.

| REVISIONS |         |   |            |    |
|-----------|---------|---|------------|----|
| REV.      | ECO. NO | DESCRIPTION   | DATE       | BY |
| A         | 682     | INITIAL RELEASE   | 7/21/2005  | TT |
| B         | 1126    | UPDATE SPECIFICATIONS   | 8/28/2006  | MV |
| C         | 1811    | UPDATE P/N CODING, FRONT & SIDE VIEWS, TOLERANCE, POSI. CHART, ADD PCB LAYOUT | 12/23/2008 | JH |

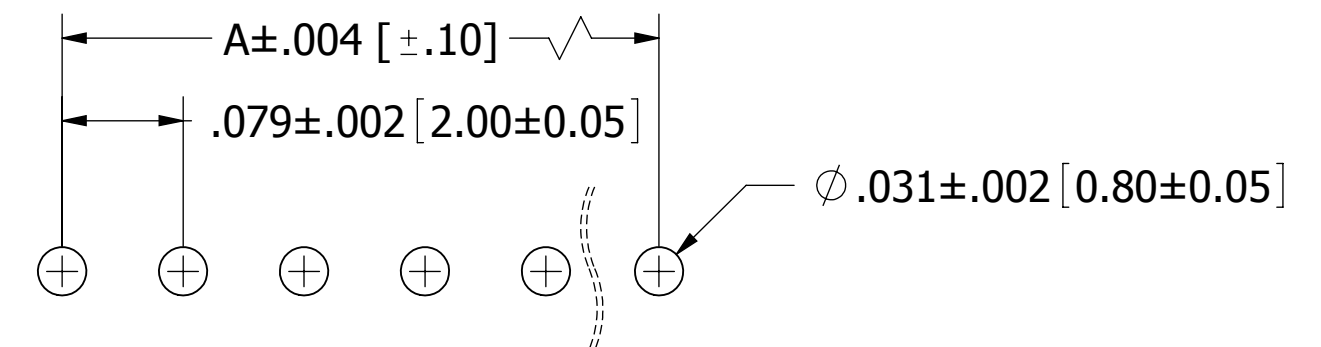
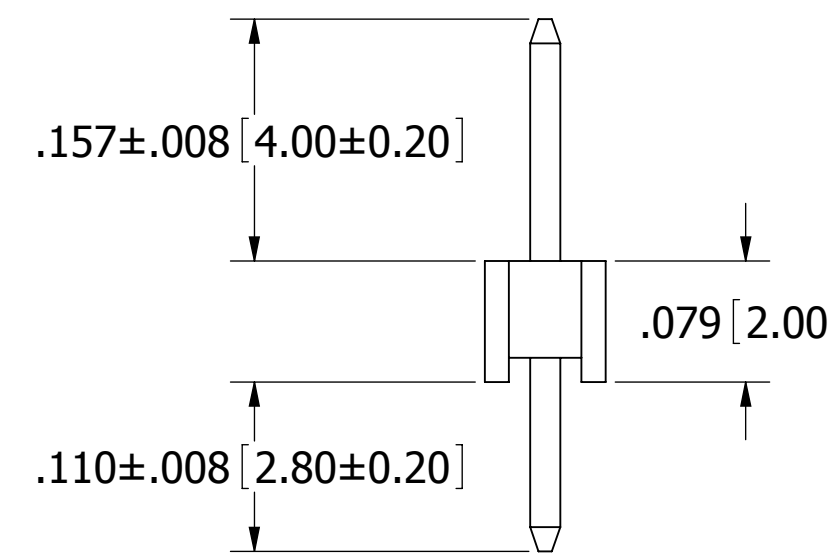
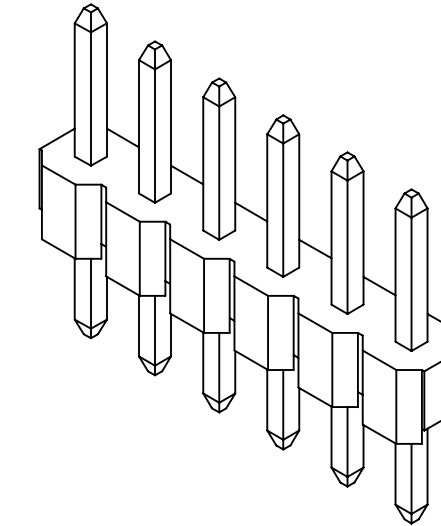

### RECOMMENDED PCB LAYOUT

### NOTES:

1. INSULATOR MATERIAL: SEE PART NUMBER CODING.
2. CONTACT MATERIAL: BRASS.
3. CONTACT PLATING: GOLD FLASH OVERALL.
4. CURRENT RATING: 1 AMP.
5. INSULATOR RESISTANCE: 5000 MEGOHMS MIN.
6. CONTACT RESISTANCE: 20 MILLIOHMS MAX.
7. DIELECTRIC WITHSTANDING: AC 500V.
8. OPERATING TEMPERATURE: -40° C TO +105° C.
9. \*PROCESSING TEMP.: 260° C FOR 10 SECS MAX.

\*INDICATED TEMPERATURE AND TIME IS FOR COMPONENT INSULATOR. HIGHER PROCESSING TEMPERATURES MAY BE USED, PROVIDED HEAT IS APPLIED FROM BACK SIDE OF PCB, AND INSULATOR DOES NOT EXCEED INDICATED TEMPERATURE AND TIME.

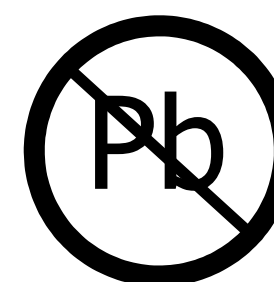

RoHS COMPLIANT

UNLESS OTHERWISE SPECIFIED:  
DIMENSIONS ARE IN INCHES[MM]  
TOLERANCES:  
ANGULAR: ± 5°  
.X = ± .012 [.30]  
.XX = ± .008 [.20]  
.XXX = ± .006 [.15]  
SURFACE FINISH: 63 R<sub>a</sub>  
REMOVE ALL BURRS AND SHARP EDGES .010 MAX

INTERPRET DIMENSIONS AND GEOMETRIC TOLERANCING PER: ANSI Y14.5M-1994

| DATE   | NAME              | SULLINS<br>CONNECTOR SOLUTIONS               |  |
|--|-------------------|--|--|
| DRAWN 12/17/08   | JH                | DESCRIPTION<br>HEADER MALE 2mm CC, 1 ROW, ST |  |
| THE INFORMATION HEREIN CONTAINS PROPRIETARY INFORMATION OF SULLINS ELECTRONICS AND IS NOT TO BE REPRODUCED, USED OR DISCLOSED TO OTHERS FOR ANY PURPOSE EXCEPT AS SPECIFICALLY AUTHORIZED IN WRITING BY AN OFFICER OF SULLINS ELECTRONICS. |                   | PART NUMBER<br><b>NRPNxx1PAEN-RC</b>         |  |
| SIZE<br><b>C</b>   | DWG. NO.<br>10531 | REV<br><b>C</b>                              |  |
| SCALE: 16:1  |                   | SHEET 1 OF 1                                 |  |